

## 1 零件名稱及數量

詳細操作影片請至Super B

官網<http://www.superbiketool.com/>觀看，點擊

Product → Wheelset truing stands → 1. → TB-PF35

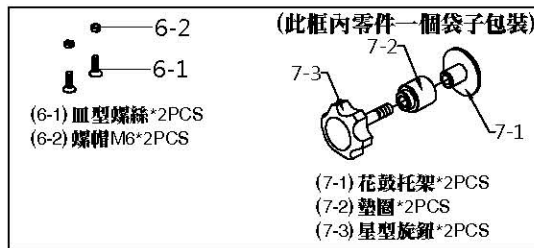
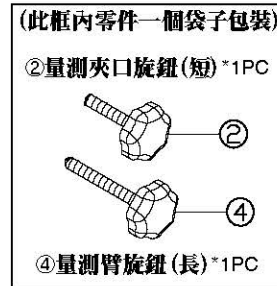
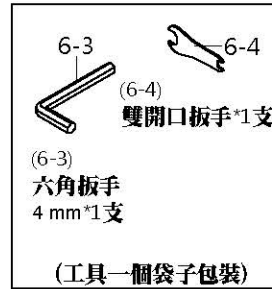
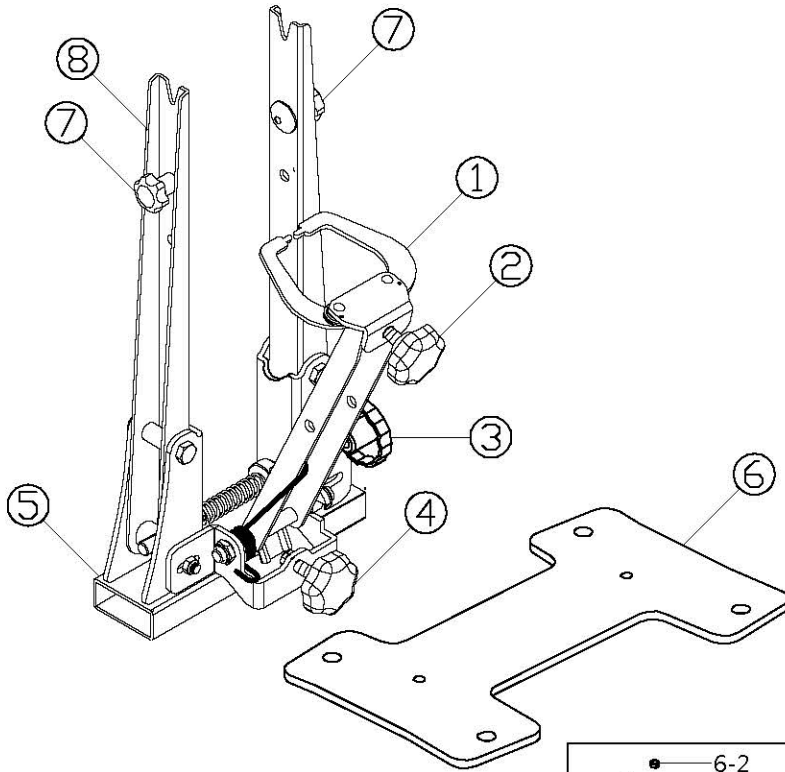

編號	名稱	數量
①	量測夾口	1
②	量測夾口旋鈕(短)	1
③	量測夾臂旋鈕	1
④	量測臂旋鈕(長)	1
⑤	校正台主體	1
⑥	底座	1
6-1	皿型螺絲	2
6-2	螺帽M6	2
6-3	六角扳手 4mm	1
6-4	雙開口扳手	1
⑦	花鼓托架組	2
7-1	花鼓托架	2
7-2	墊圈	2
7-3	星型旋鈕	2
⑧	輪組夾臂	2

## 2 組裝步驟

1. 利用雙開口扳手(6-4)與六角扳手 4mm(6-3)組裝校正台主體⑤與底座⑥。(如圖一所示)
2. 組裝量測夾口旋鈕(短)②，量測臂旋鈕(長)④與花鼓托架組⑦。(如圖二所示)

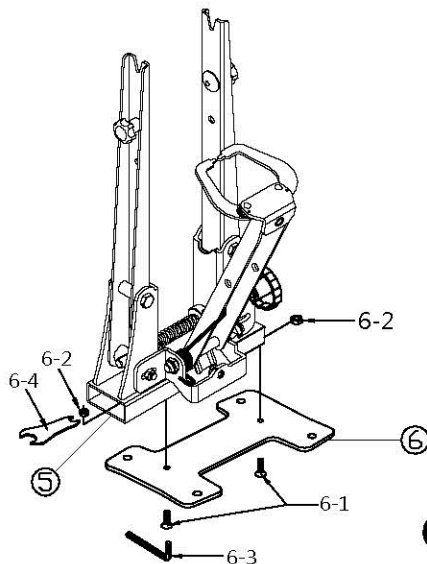

(圖一)

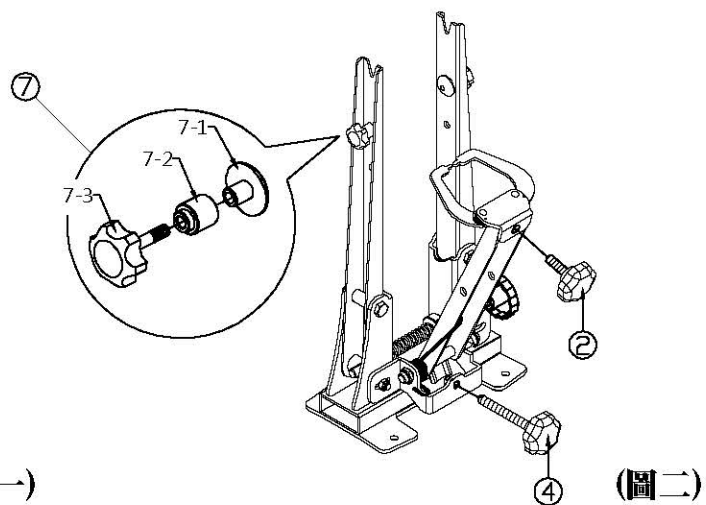

(圖二)



組裝時請注意底座⑥方向，較長的一邊須朝向使用者方向

### 3 使用說明

**輪圈校正:**

1. 固定花鼓於輪組夾臂⑧上，適用於快拆軸心與一般有牙軸心花鼓。(如圖三所示)
2. 當花鼓為直通軸心花鼓 (12~20mm)，請將花鼓托架組⑦固定於輪組夾臂⑧頂端。(如圖四所示)
3. 調整量測夾口旋鈕(短)②與量測臂旋鈕(長)④設定量測夾口①位置。(如圖五、六所示)
  - 3-1. 放鬆量測夾口旋鈕(短)②可使量測夾口①靠近輪圈用以進行輪圈偏擺校正。(如圖五、七所示)
  - 3-2. 放鬆量測臂旋鈕(長)④可使量測夾口①靠近輪圈用以進行輪圈正圓校正。(如圖六、八所示)
4. 請搭配使用輪組中心定位量規(TB-1930) (選購) 測量輪組中心。
5. 重複步驟3-4調整輪圈。
6. 建議使用輪圈校正台校正量規(TB-PF33) (選購)，檢查與調整輪圈校正台。
7. 可選購百分錶與萬向錶座(TB-PF22)用於量測碟盤與更精確地量測輪組。

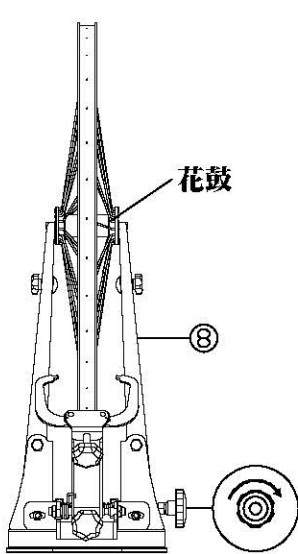

(圖三)

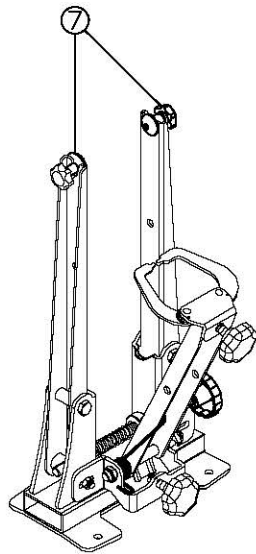

(圖四)

**!** 請確實固定花鼓於輪組夾臂⑧以確保校正精準度

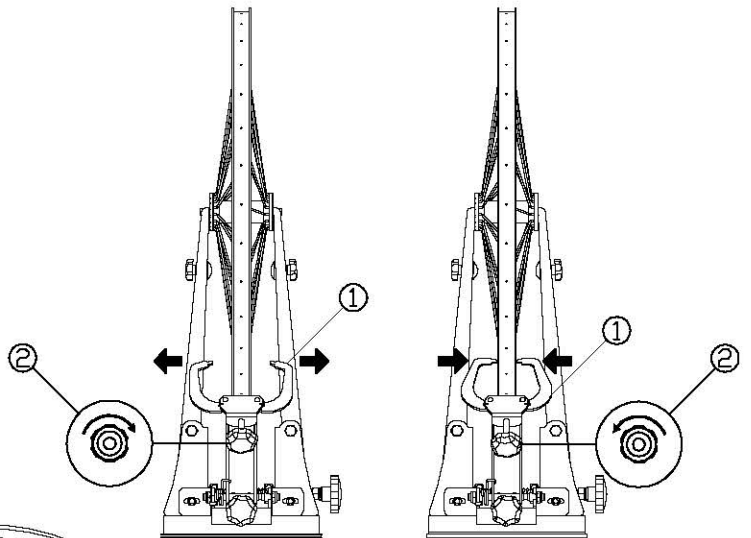

(圖五)

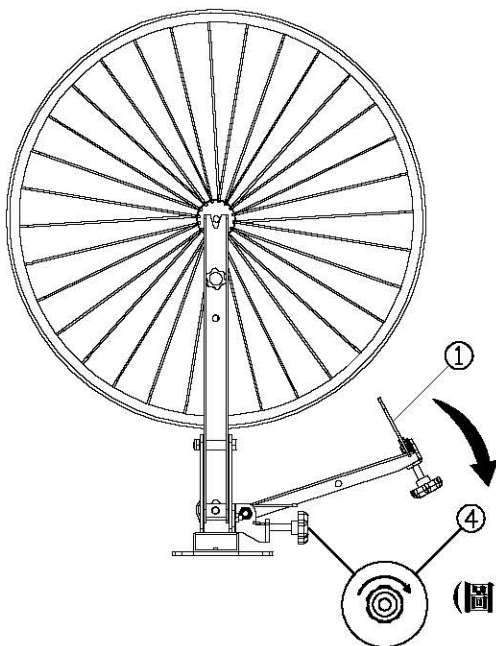

(圖六)

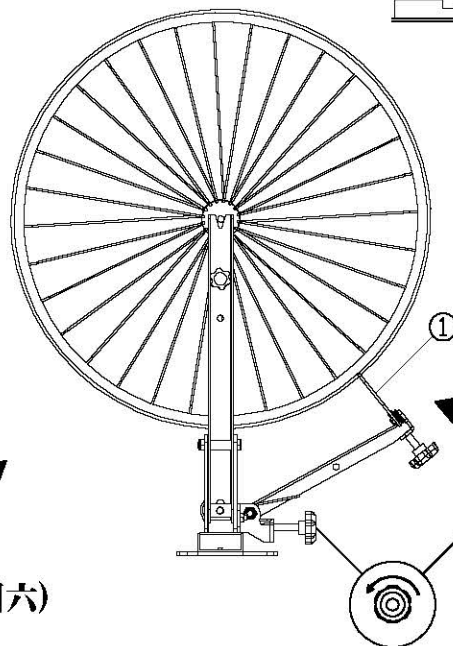

(圖七)

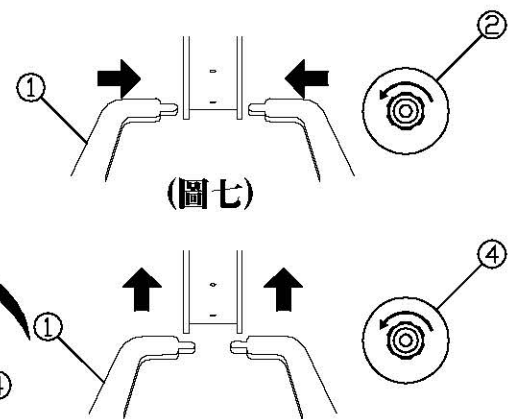

(圖八)

## 1 Parts description

Visit operation detail at Super B  
Website: <http://www.superbiketool.com/>,  
Click Product ➔ Wheelset truing stands ➔ 1. ➔ TB-PF35

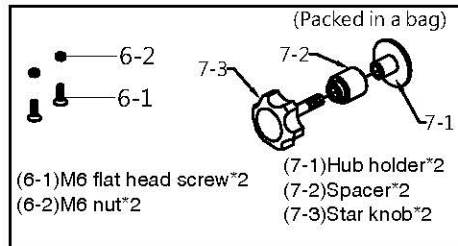
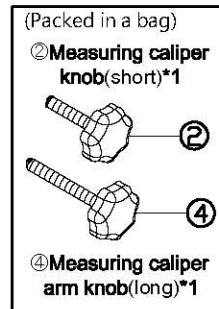
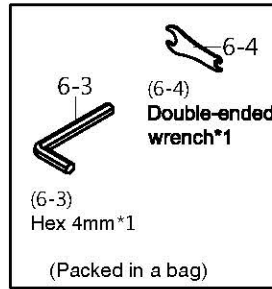
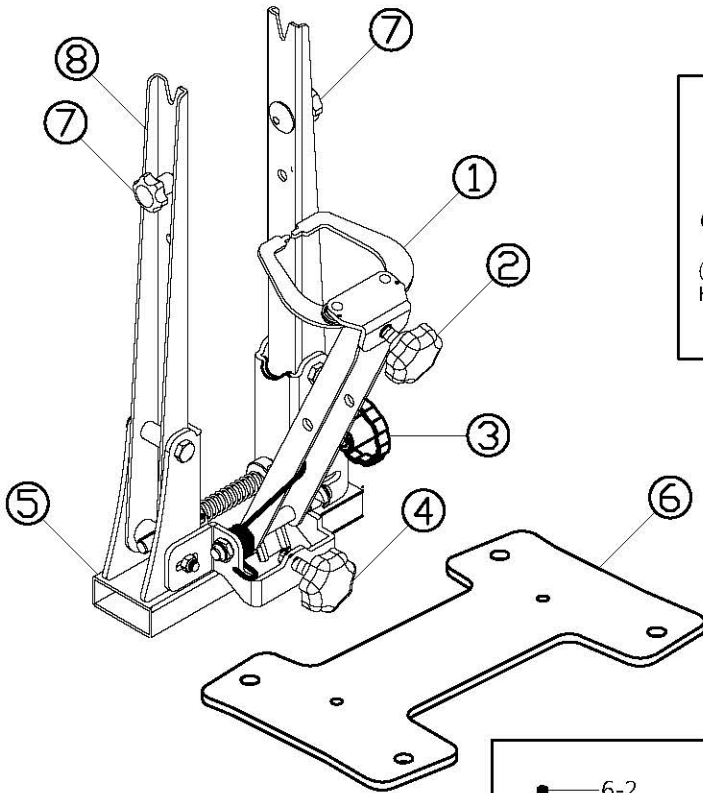

NO	PARTS	Q'TY
①	Measuring caliper	1
②	Measuring caliper knob(short)	1
③	Measuring upright knob	1
④	Measuring caliper arm knob(long)	1
⑤	Body	1
⑥	Base	1
6-1	M6 flat head screw	2
6-2	M6 nut	2
6-3	Hex wrench 4mm	1
6-4	Double-ended wrench	1
⑦	Hub holder set	2
7-1	Hub holder	2
7-2	Spacer	2
7-3	Star knob	2
⑧	Upright	2

## 2 Assembly

1. Assemble body ⑤ and base ⑥ together by using double-ended wrench (6-4) and hex wrench 4mm (6-3). (see picture 1)
2. Install measuring caliper knob (short) ②, measuring caliper arm knob (long) ④ and hub holder sets ⑦. (see picture 2)

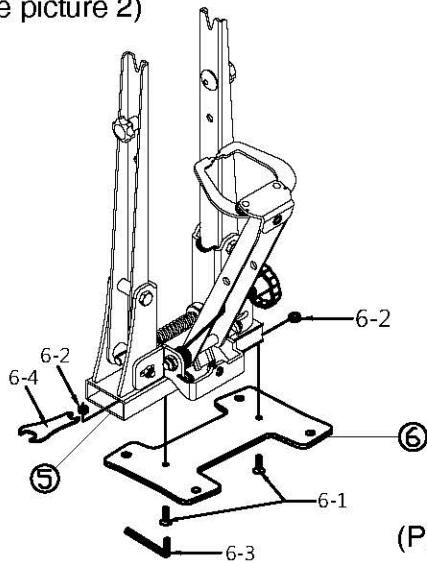

(Picture 1)

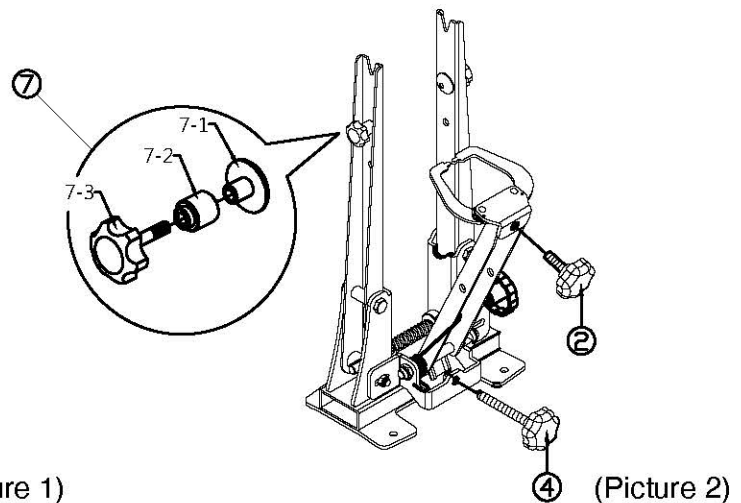

(Picture 2)



Be aware of the direction of base ⑥.  
The longer side should face the operator

**3 Instruction**

Rim truing

1. Set the hub on uprights ⑧ which are suitable for quick-release hub and threaded hub. (see picture 3)
2. If the hub is a thru-axle hub (12 to 20 mm), please set the hub holder sets ⑦ on the top of uprights ⑧. (see picture 4)
3. Set up the measuring caliper ① by adjusting measuring caliper knob(short) ② and measuring caliper arm knob(long) ④. (see picture 5 & 6)
  - 3-1. Proceed radial truing of rim by loosening measuring caliper knob(short) ② and make the measuring caliper ① to be close to the rim. (see picture 5 & 7)
  - 3-2. Proceed the lateral truing of rim by loosen measuring caliper arm knob(long) ④ and make the measuring caliper ① to be close to the rim. (see picture 6 & 8)
4. We suggest truing with wheel alignment gauge (TB-1930)(optional).
5. Repeat step 3~4 until the wheelset truing is completed.
6. Check and calibrate it with truing stand correction gauge(TB-PF33)(optional).
7. Adding dial indicator & all-purpose arm set(TB-PF22)(optional) can be used for rotor truing and more accurate wheelset truing.

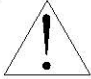
 Please securely fix the hub on uprights ⑧ to ensure the truing accurately

