

1 Parts Description

Visit operation detail at Super B
Website: <http://www.superbiketool.com/>,
Click Product → Wheel & Spoke → 1. → TB-1930

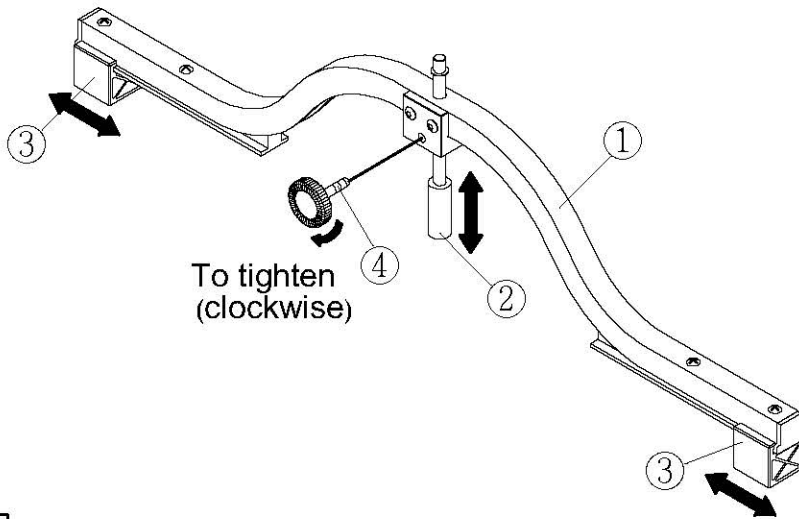

NO.	PART	Q'TY
①	Body	1
②	Gauge	1
③	Sliding block	2
④	Gauge knob	1

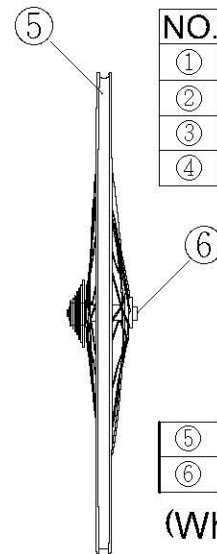

⑤	Rim	1
⑥	Hub axle	1

(Wheelset not include)

2 Assembly

Tighten the gauge knob ④ clockwise into body ①.

3 Instruction

- Loosen the gauge knob ④ to let gauge ② freely move, then adjust the sliding blocks ③ to proper position of the edge of rim. Put the wheel alignment gauge onto rim, make gauge ② real contact with hub axle ⑥, sliding block ③ real contact with rim ⑤, then tighten the gauge knob ④ for setting benchmark. (see picture 1)
- Place the gauge with set benchmark to opposite side.

There will be 3 conditions as below :

 - When 3 points are real contact TB-1930, it means the wheelset is even. (see picture 2)
 - When rim ⑤ are real contact TB-1930 except hub axle ⑥, it means the wheelset is uneven. (see picture 3)
 - When hub axle ⑥ is real contact TB-1930 except rim ⑤, it means the wheelset is uneven. (see picture 4)
- To gauge the front as same as rear wheelset.

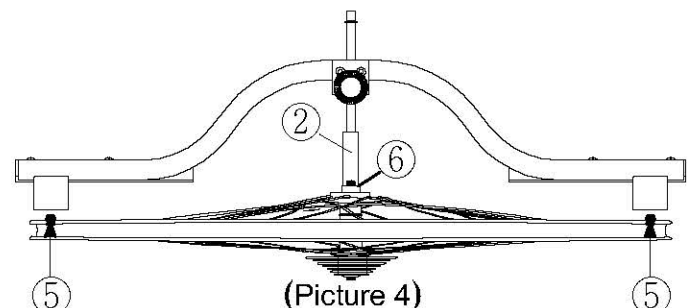
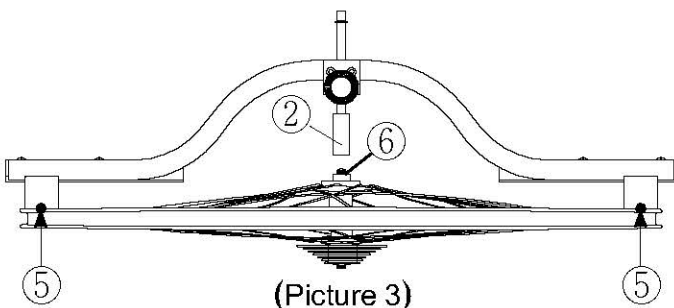
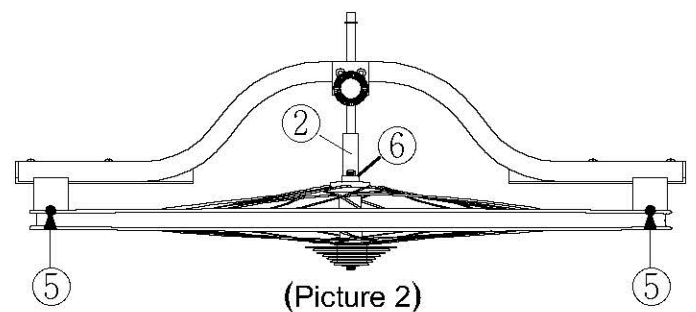
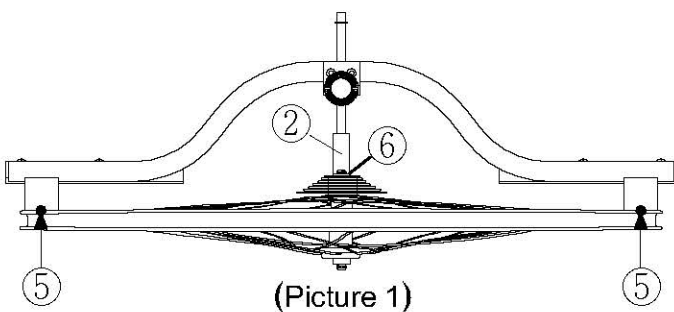

詳細操作影片請至 Super B
官網 <http://www.superbiketool.com/> 觀看，點擊
Product → Wheel & Spoke → 1. → TB-1930

1 零件名稱及數量

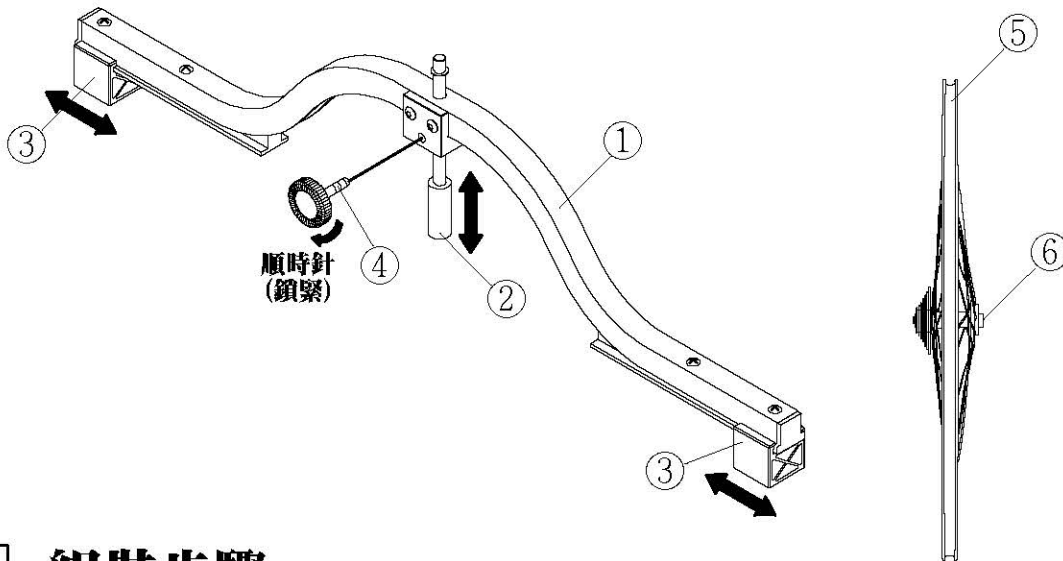

項次	名稱	數量
①	量規主體	1
②	測量桿	1
③	量規滑塊	2
④	旋鈕	1

⑤	輪框	1
⑥	花鼓軸心	1

(產品不含輪組)

2 組裝步驟

將旋鈕④順時針方向旋入量規主體①即可完成組裝。

3 使用說明

- 將旋鈕④鬆開，使測量桿②呈可移動狀態，並調整量規滑塊③至輪框邊緣適當位置。將量規置於輪組上，使測量桿②接觸花鼓軸心⑥，量規滑塊③接觸到輪框⑤，並旋緊旋鈕，完成基準點設定。(如圖一所示)
- 將已設定好基準點的量規，接觸輪組另一面。接觸後會有以下情形：
 - 若TB-1930與三點均接觸，表示輪組左右對稱。(如圖二所示)
 - 若TB-1930接觸輪框⑤，無接觸花鼓軸心⑥，表示輪組不對稱。(如圖三所示)
 - 若TB-1930接觸花鼓軸心⑥，無接觸輪框⑤，表示輪組不對稱。(如圖四所示)
- 前後輪測量方式均同。

