

NO	PARTS	Q'TY
①	Extension tube	1
②	Quick release clamp	1
③	Main tube	1
④	Hanger unit	2
4-1	Hanger	4
4-2	Spring washer	6
4-3	Small washer	12
4-4	Turning knob	4
4-5	Bolt	2
4-6	M6 nylon nut	2
4-7	M6 nut	4
4-8	Holding bar	2
⑤	Hanger unit adaptor	2
5-1	Adjusting knob	2
5-2	Washer	2
5-3	Balance adjusting unit (S)	2
5-4	Balance adjusting unit (L)	2
5-5	Sex bolt	4
5-6	Plastic pad	2set
5-7	Spacer	1
5-8	U bolt	2
5-9	Carriage bolt	2

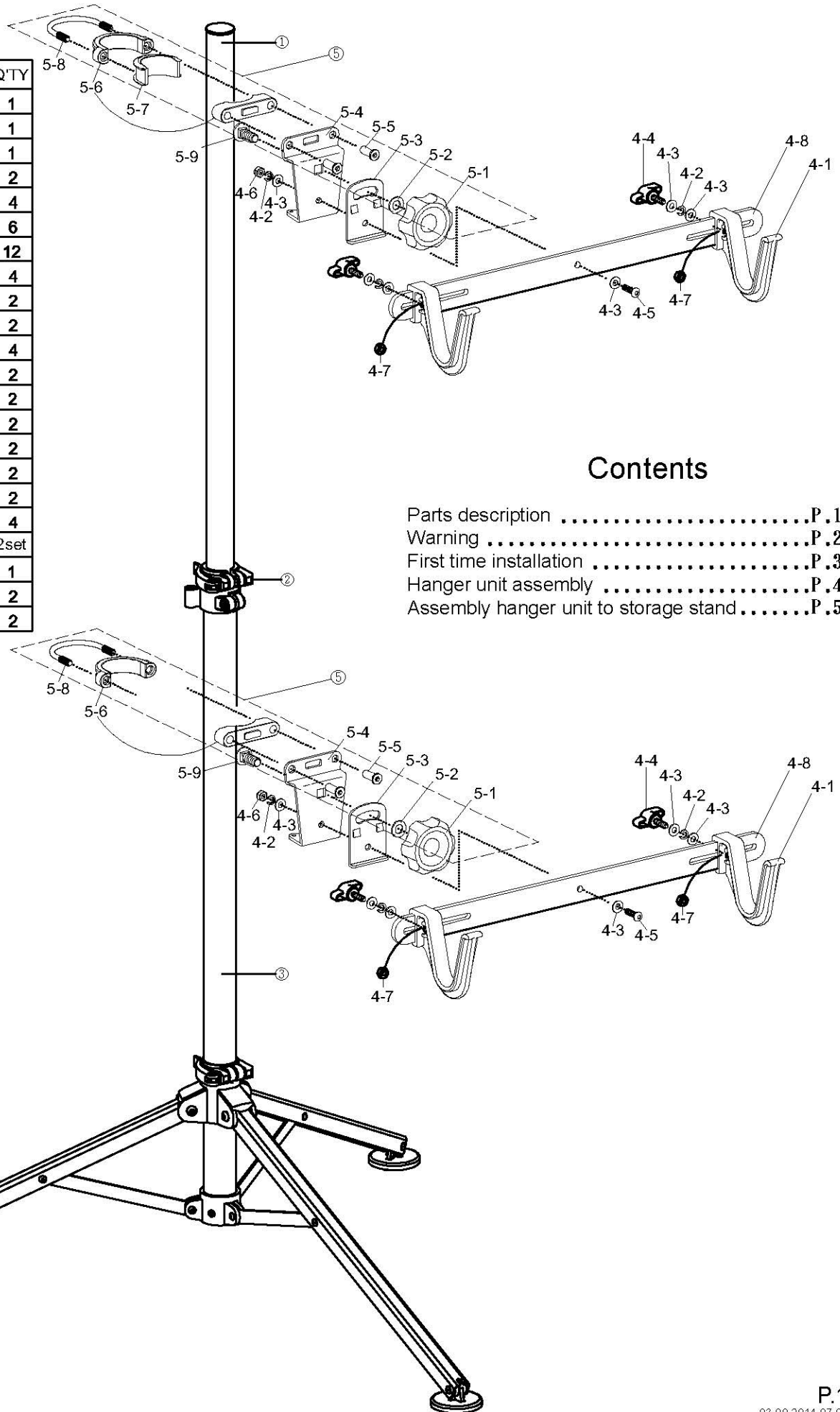

### Contents

Parts description .....	P.1
Warning .....	P.2
First time installation .....	P.3
Hanger unit assembly .....	P.4
Assembly hanger unit to storage stand .....	P.5

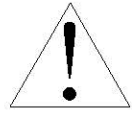

## Warning

1. Please follow this instruction to operate the product, or it may cause the collapse of the storage stand, injury and property damage.
2. Please install only on solid and flat floor.
3. The maximum weight capacity for the storage stand is 72 kg (158.7 lbs).  
The maximum weight capacity for a hanger unit is 18 kg (39.7 lbs).  
(Each hanger unit is for one bike only).
4. The storage stand can be installed up to 4 hanger units as maximum  
(2 hanger units are included). The extra 2 hanger units must be installed  
at the back of installed hanger units.
5. Please don't bump into the storage stand, or please recheck the stability  
by following the instruction for the safety if it accidental collision happens.
6. Please check the stability of storage stand regularly. First of all, take the  
bikes off from the storage stand. Slightly shake the storage stand to  
ensure the stability of all parts.  
If there is any loosening part after shaking, please reinstall and tighten  
the parts and recheck until they are all firmly fixed.

## LIMITATION OF LIABILITY

None of manufacturer, distributor, and retailer shall be held liability for any claim of personal injury or property damage as a result of user crash, abuse, improper installation, overloading, product modification or poor quality of installation places.

1 Insert extension tube ① into the main tube ③.

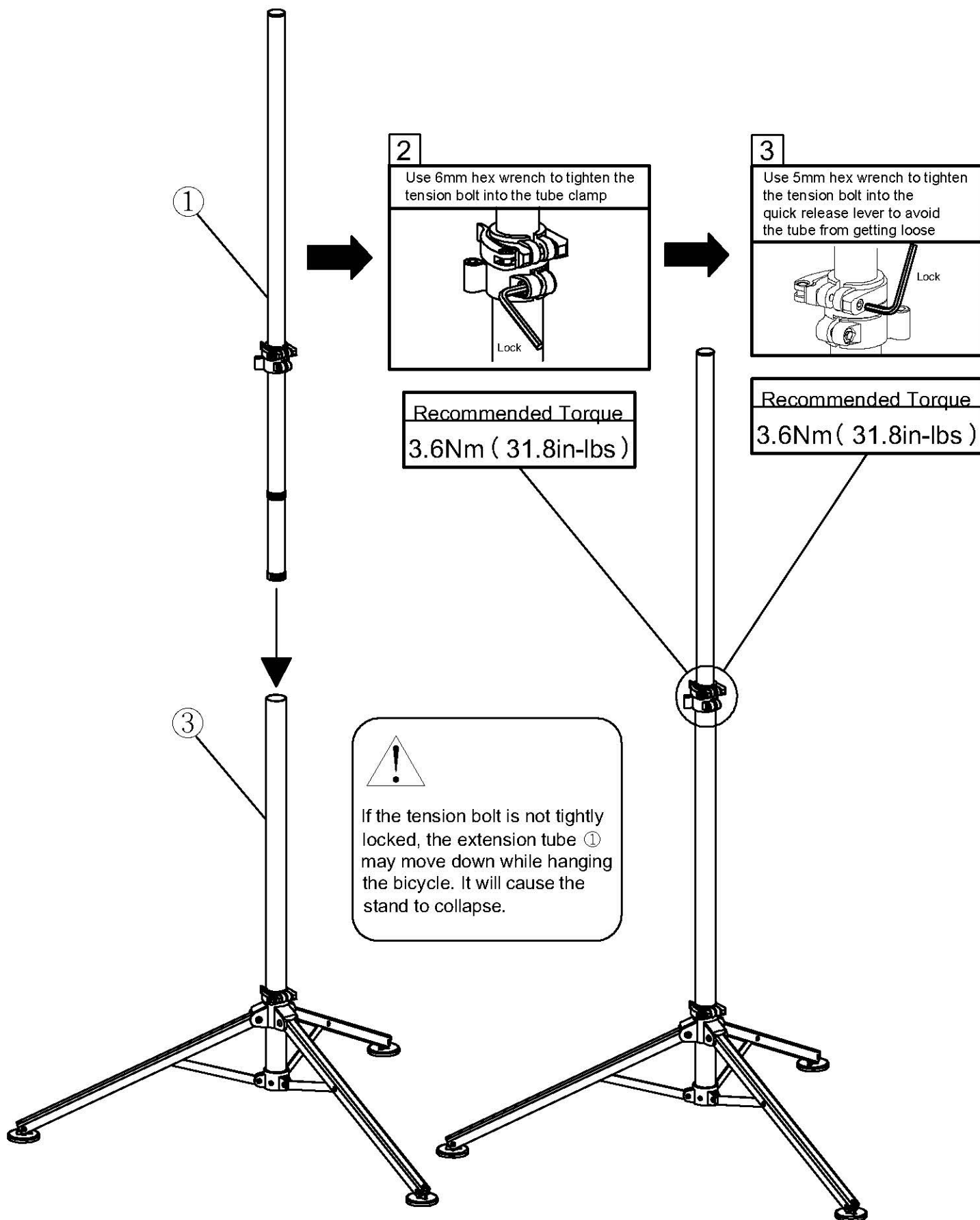

## 1 Hanger assembly

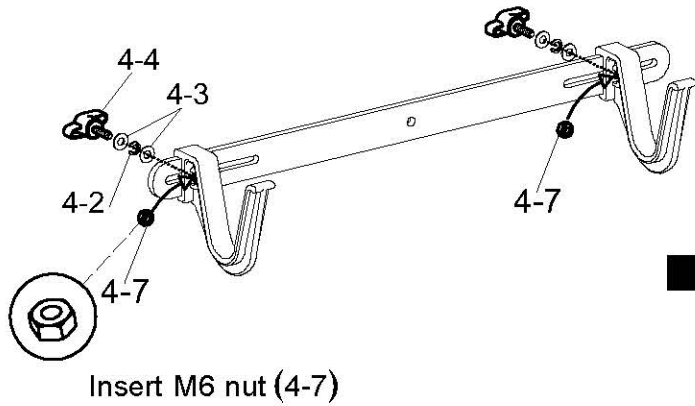

Insert M6 nut (4-7)

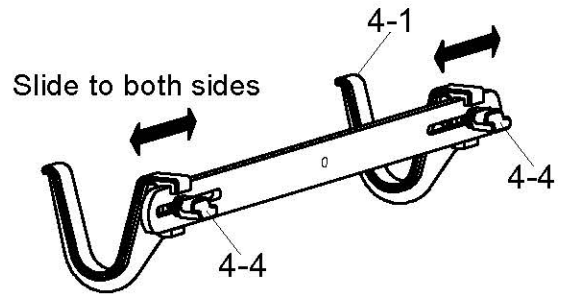

Slide to both sides

Adjust the hanger (4-1) to your needed position and then tighten the turning knob (4-4)

## 2 Assembly of the hanger unit and hanger unit adaptor

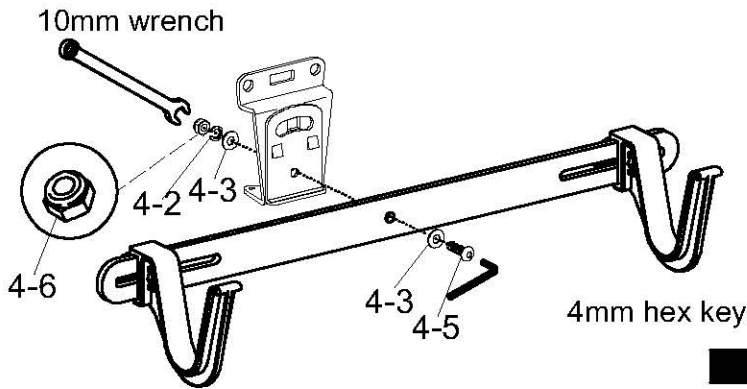

Use 10mm wrench to fasten M6 nylon nut (4-6)  
Then use 4mm hex key to tighten the bolt (4-5)

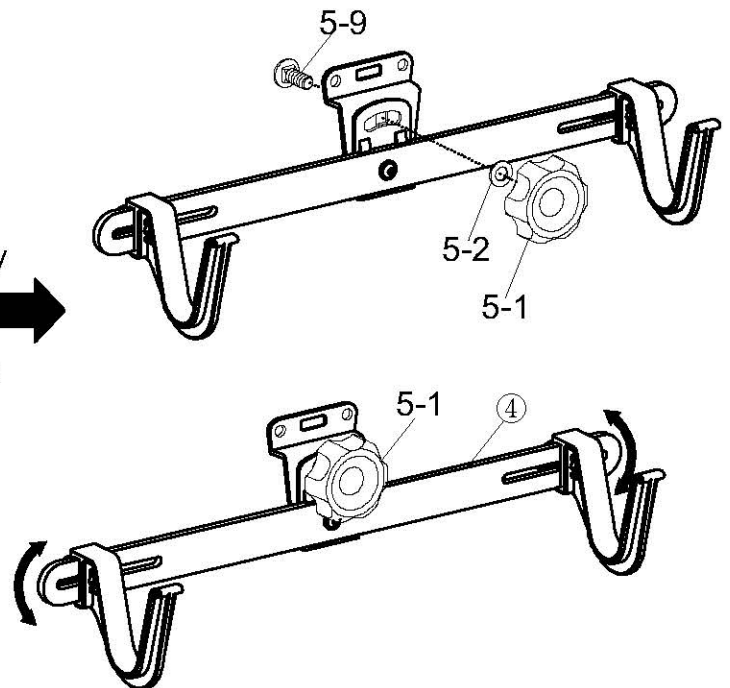

Turn the adjusting knob (5-1) to adjust the hanger unit ④ angle and then tighten the adjusting knob (5-1)

⚠

Ensure that the knobs(5-1)of hanger units ④ are in alignment with one of the legs of the stand. Otherwise, it may cause the stand to collapse after hanging the bicycle.

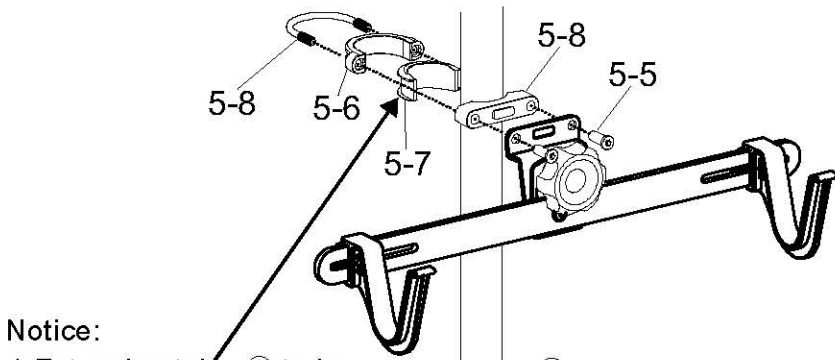

Notice:  
1.Extension tube ① to be secured with "spacer (5-7)"  
2.Main tube ③ to be secured without "spacer (5-7)"

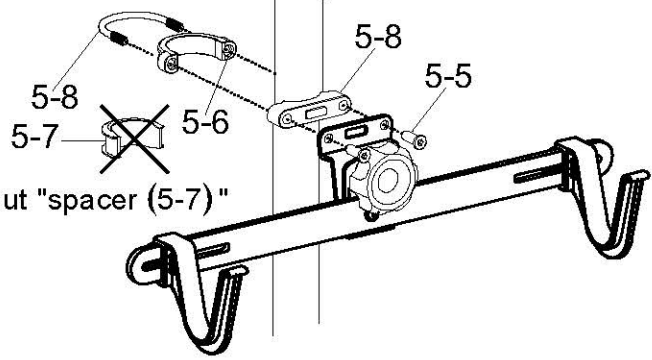

Notice: without "spacer (5-7)"

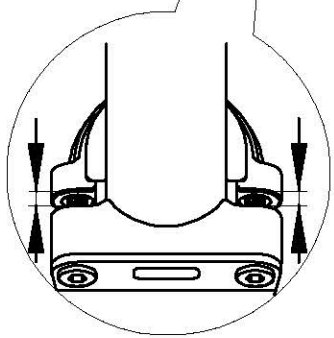
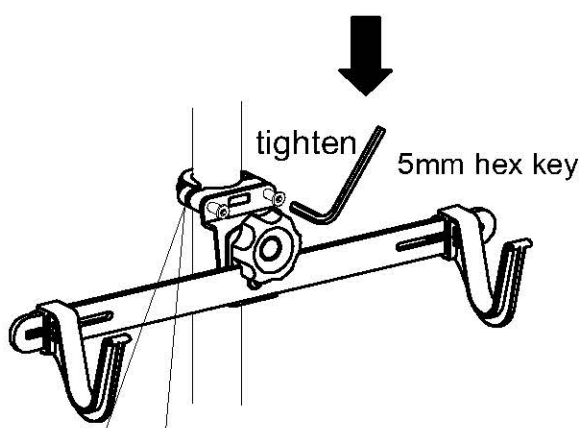

⚠ When tightening (loosening) the sex bolt (5-5), exert evenly fastening and control the same reach for both sides. Then, tighten two sex bolts (5-5). (If removal is needed, loosen the nuts first. Then, tighten them after adjustment)

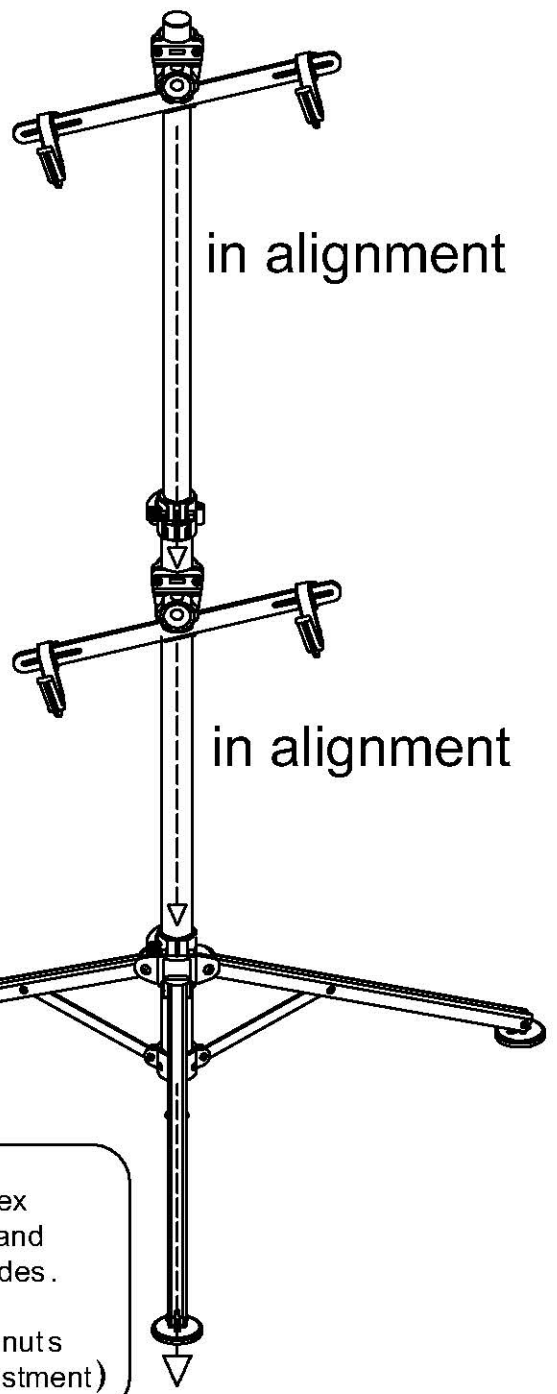

編號	名稱	數量
①	延長管	1
②	快拆座	1
③	主體管	1
④	掛勾組	2
4-1	掛勾	4
4-2	彈簧華司	6
4-3	小華司	12
4-4	一字旋鈕	4
4-5	半丸頭螺絲	2
4-6	尼龍螺母M6	2
4-7	螺母M6	4
4-8	橫桿	2
⑤	掛勾組調整器	2
5-1	大旋鈕	2
5-2	大華司	2
5-3	小固定座	2
5-4	大固定座	2
5-5	長頸螺帽	4
5-6	迫緊塑膠件	2組
5-7	管墊環	1
5-8	U型螺栓	2
5-9	馬車螺絲	2

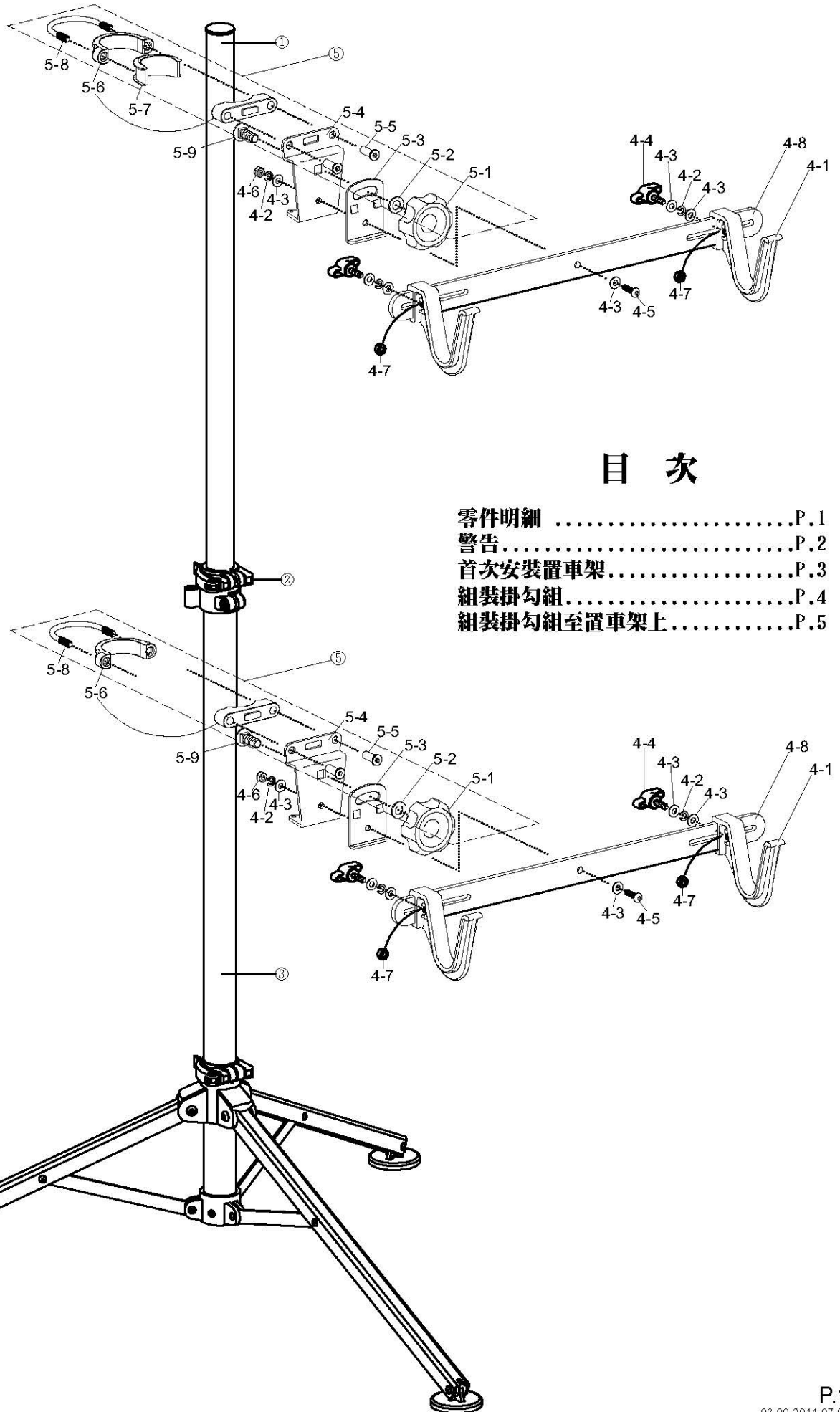

## 目次

零件明細 ..... P.1  
 警告..... P.2  
 首次安裝置車架..... P.3  
 組裝掛勾組..... P.4  
 組裝掛勾組至置車架上..... P.5



## 警告

1. 請依照說明書進行產品操作，否則可能會導致置車架及自行車倒塌，造成受傷或者財物受損。
2. 請務必安裝置車架在穩固且平坦的地面上。
3. 此置車架最大總承受重量為 72 公斤 (158.7 磅)。每一掛勾組最大承受重量為 18 公斤 (39.7 磅)。(僅可掛一輛自行車)
4. 此置車架可安裝至四個掛勾組 (內含兩組)，另外購買的兩個掛勾組須被安裝在原掛勾組的背面。
5. 切勿碰撞到已安裝好的置車架；若意外碰撞到了置車架，務必確實依照說明書重新檢查，以確保其安全性。
6. 請務必進行定期的置車架穩固檢查：  
先將置車架上的自行車取下後，輕搖置車架，確認所有部位皆無鬆動，以確保其穩固性。若是置車架鬆脫，重新調整高度及安裝，再測試一次，直至穩固為止。

### 責任歸屬

製造商、任意代理商或經銷商，對於因消費者之碰撞、濫用、不當安裝、超過負載、不當使用、變造產品或不適當的安裝場所而導致受傷或財物損失，不負相關責任。

1 將延長管①裝入主體管③。

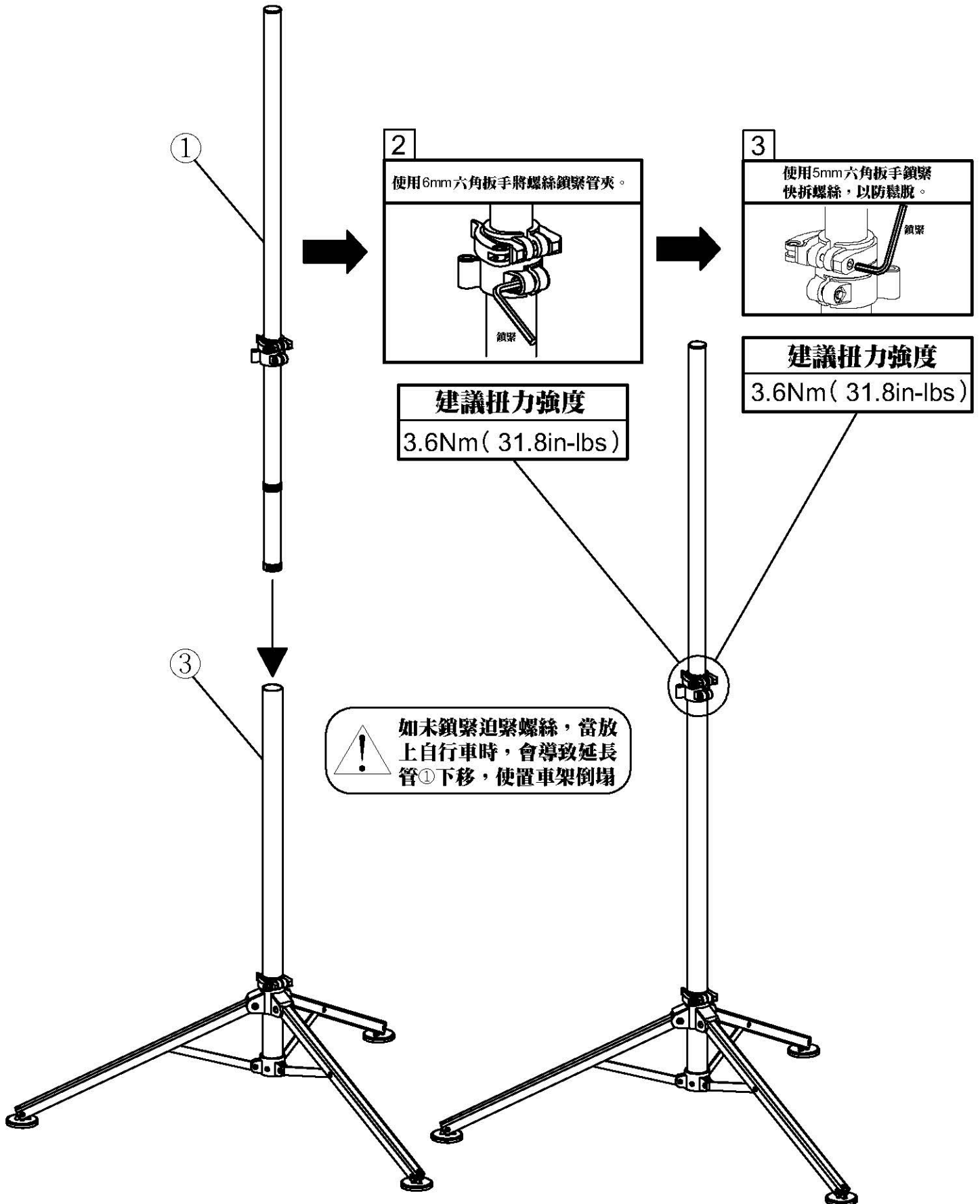



## 1 掛勾組組合

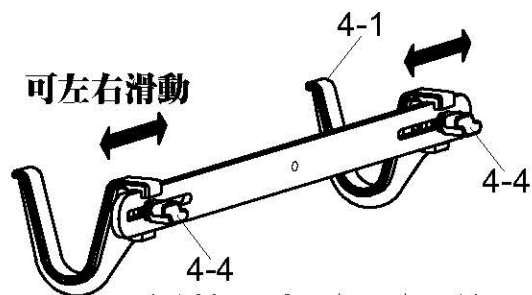
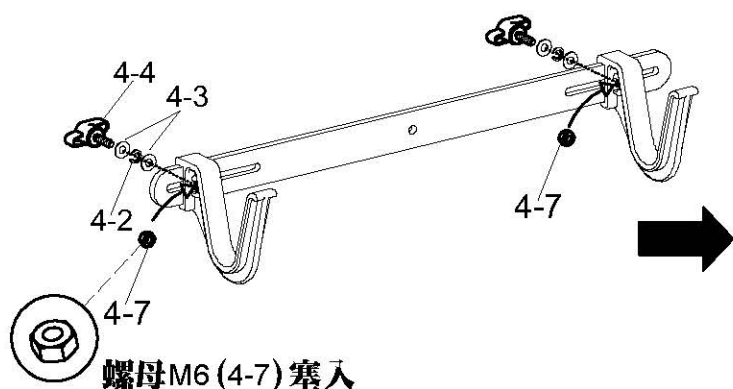

調整掛勾 (4-1) 至適當位置並旋緊一字旋鈕 (4-4)

## 2 掛勾組與固定座結合

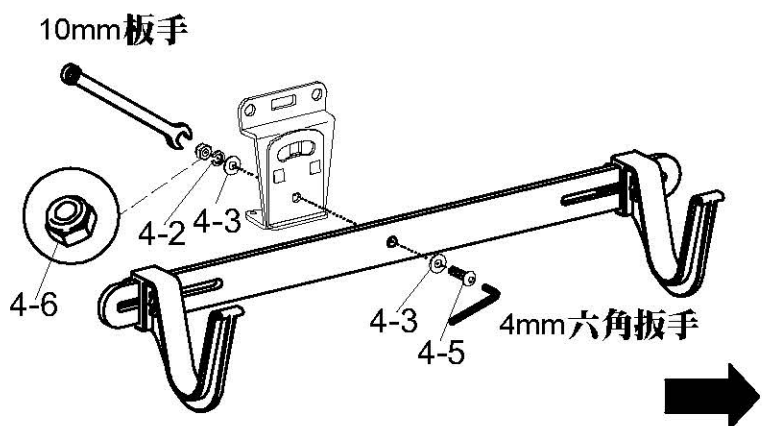

使用"10mm 扳手"固定尼龍螺母M6 (4-6) 後，  
使用"4mm 六角扳手"旋緊半丸頭螺絲 (4-5)

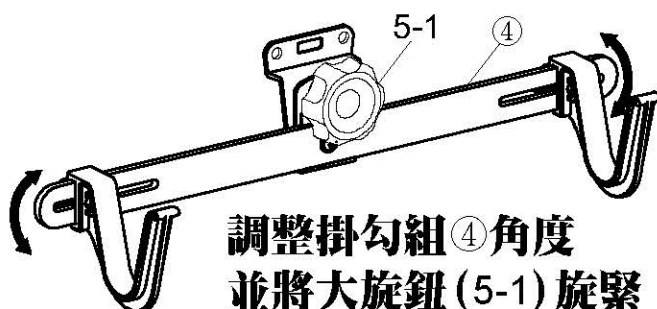
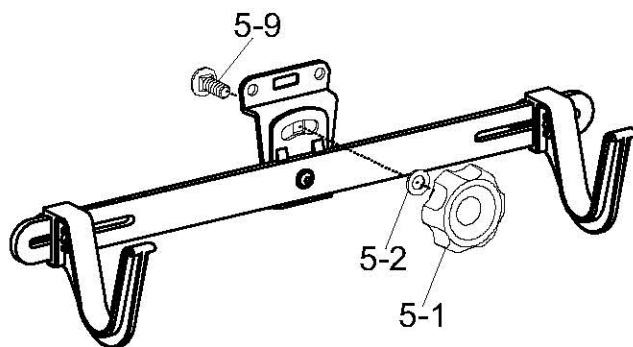

調整掛勾組④角度  
並將大旋鈕 (5-1) 旋緊



務必確保掛勾組④大旋鈕(5-1)與三支腳中任何一支腳架成一  
直線(如圖示)，以免放上自行  
車後，置車架不穩而倒塌。

注意：

1. 延長管①須套此  
"管墊環"(5-7)

2. 主體管③不套用(5-7)

注意：不套用(5-7)

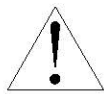
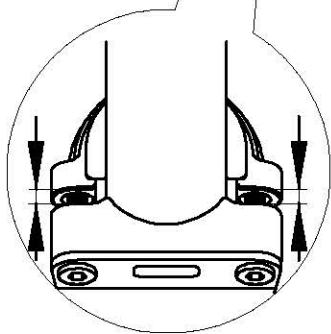
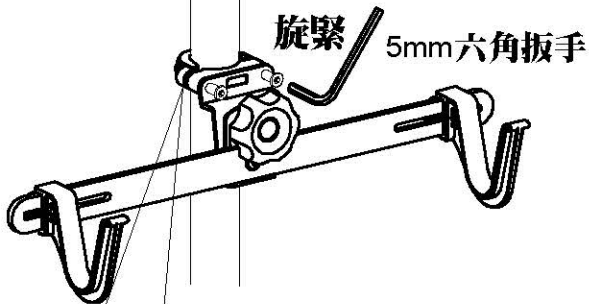
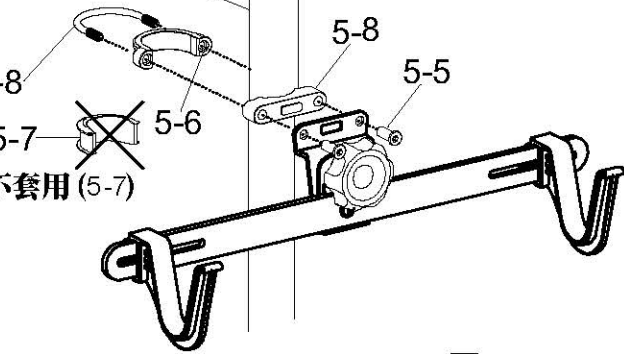
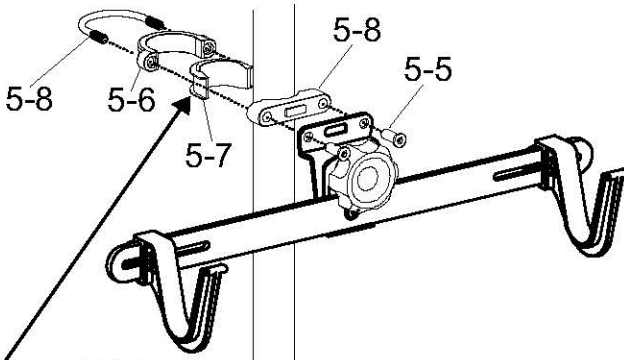

轉緊(放鬆)長頸螺帽(5-5)時，  
務必平均施力，務必控制兩邊  
間距一樣，輪流轉動2顆長頸螺  
帽(5-5)，直至逼緊。(如須移動  
請鬆開，調整位置後再旋緊)

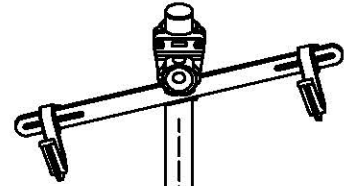

對齊

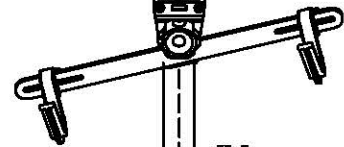

對齊